

Tiffany



MODEL NUMBER

DESCRIPTION

W x D x H

WEIGHT

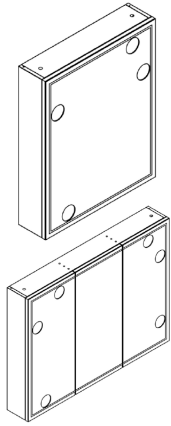

130922

130920 (left hinges)	Mirror cabinet W60 1 door - 2 adjustable glass shelves Front lighting: 4 LED spots - 580 lumen - 4100°K, LED spot power - 3W, underneath LED power 4.8W Energy class: A+/A+/A	23 ⁵ / ₈ " x 5 ⁷ / ₈ " x 29 ¹ / ₂ "	20kgs
130924 (right hinges)			
130921	Mirror cabinet W80 3 doors - 6 adjustable glass shelves Front lighting: 6 LED spots - 580 lumen - 4100°K, LED spot power - 3W, underneath LED power 5.76W Energy class: A+/A+/A	31 ¹ / ₂ " x 5 ⁷ / ₈ " x 29 ¹ / ₂ "	23kgs
130922	Mirror cabinet W100 3 doors - 6 adjustable glass shelves Front lighting: 6 LED spots - 580 lumen - 4100°K, LED spot power - 3W, underneath LED power 8.16W	39 ³ / ₈ " x 5 ⁷ / ₈ " x 29 ¹ / ₂ "	26kgs
130923	Mirror cabinet W120 3 doors - 6 adjustable glass shelves Front lighting: 6 LED spots - 580 lumen - 4100°K, LED spot power - 3W, underneath LED power 10.08W	47 ¹ / ₄ " x 5 ⁷ / ₈ " x 29 ¹ / ₂ "	30kgs

Included with all: Switch for underneath lighting, shaver socket, switch/dimmer for front spots. Lighting: class II - IP44 - CE

Divine

MODEL NUMBER

DESCRIPTION

W x D x H

WEIGHT

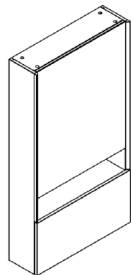
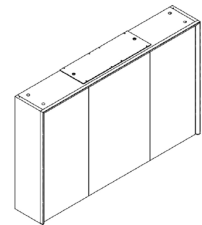
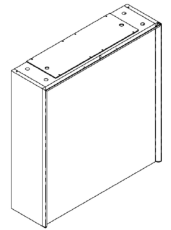

130900.1 (lacquer)	Mirror cabinet W60 1 door left hinging (reversible) 2 adjustable glass shelves LED lighting: 95 lumen - 4500°K LED power - 17.76W	23 ⁵ / ₈ " x 7 ¹ / ₁₆ " x 24 ⁷ / ₁₆ "	20kgs
130900.2 (wood décor)			
130901.1 (lacquer)	Mirror cabinet W80 3 doors - 6 adjustable glass shelves, LED lighting: 95 lumen - 4500°K LED power - 19.68W	31 ¹ / ₂ " x 7 ¹ / ₁₆ " x 24 ⁷ / ₁₆ "	23kgs
130901.2 (wood décor)			
130902.1 (lacquer)	Mirror cabinet W100 3 doors - 6 adjustable glass shelves, LED lighting: 95 lumen - 4500°K LED power - 21.60W	39 ³ / ₈ " x 7 ¹ / ₁₆ " x 24 ⁷ / ₁₆ "	26kgs
130902.2 (wood décor)			
130903.1 (lacquer)	Mirror cabinet W120 3 doors - 6 adjustable glass shelves, LED lighting: 95 lumen - 4500°K LED power - 23.52W	47 ¹ / ₄ " x 7 ¹ / ₁₆ " x 24 ⁷ / ₁₆ "	30kgs
130903.2 (wood décor)			
130905 (lacquer/ right hinges)			
130904 (lacquer/ left hinges)	Cosmetic cabinet W60 1 door, 1 drop-down door 2 adjustable glass shelves LED lighting: 95 lumen - 4500°K LED power - 17.76W	23 ⁵ / ₈ " x 7 ¹ / ₁₆ " x 44 ¹ / ₁₆ "	28kgs
130907 (wood décor/ right hinges)			
130906 (wood décor/ left hinges)			

Included with all: Switch, shaver socket. Lighting: class II - IP44 - CE, energy class A+/A+/A



*Egoiste*MODEL
NUMBER

DESCRIPTION

W x D x H

WEIGHT

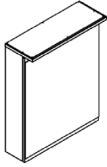
**181236.1**
(lacquer)Mirror cabinet W55
1 door left hinging (reversible) - 2
adjustable glass shelves
LED lighting: 5.04W - socket 230V
Class II - IP 44 - CE
Energy class: A++/A+/A21 $\frac{1}{2}$ " x 8 $\frac{1}{16}$ " x 27 $\frac{3}{16}$ "

16kgs

181236.2
(wood décor)*Trévise*MODEL
NUMBER

DESCRIPTION

W x D x H

WEIGHT

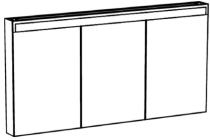
**123467**Mirror cabinet W75
3 double-sided mirror doors
Fluorescent lighting: 1x18W - T829 $\frac{1}{2}$ " x 5 $\frac{1}{8}$ " x 28 $\frac{3}{4}$ "

25kgs

123468Mirror cabinet W100
3 double-sided mirror doors
Fluorescent lighting: 1x30W - T839 $\frac{3}{8}$ " x 5 $\frac{1}{8}$ " x 28 $\frac{3}{4}$ "

32kgs

123470Mirror cabinet W120
3 double-sided mirror doors
Fluorescent lighting: 2x18W - T847 $\frac{1}{4}$ " x 5 $\frac{1}{8}$ " x 28 $\frac{3}{4}$ "

39kgs

123471Mirror cabinet W140
3 double-sided mirror doors
Fluorescent lighting: 2x30W - T855 $\frac{1}{8}$ " x 5 $\frac{1}{8}$ " x 28 $\frac{3}{4}$ "

42kgs

123469Mirror cabinet W150
3 double-sided mirror doors
Fluorescent lighting: 2x30W - T859" x 5 $\frac{1}{8}$ " x 28 $\frac{3}{4}$ "

48kgs

Included with all: 3 double-sided mirror doors, 6 adjustable glass shelves, shaver socket, light switch
Lighting: class II - IP44 - CE, Energy class: A++/A+/A*Elite*MODEL
NUMBER

DESCRIPTION

W x D x H

WEIGHT

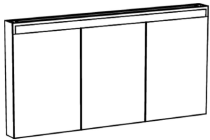
**130700**Mirror cabinet W75
3 double-sided mirror doors
LED lighting: 12.96W + 5.76W (under)29 $\frac{1}{2}$ " x 5 $\frac{1}{8}$ " x 28 $\frac{3}{4}$ "

25kgs

130701Mirror cabinet W100
3 double-sided mirror doors
LED lighting: 17.76W + 8.16W (under)39 $\frac{3}{8}$ " x 5 $\frac{1}{8}$ " x 28 $\frac{3}{4}$ "

32kgs

130702Mirror cabinet W120
3 double-sided mirror doors
LED lighting: 21.60W + 10.08W (under)47 $\frac{1}{4}$ " x 5 $\frac{1}{8}$ " x 28 $\frac{3}{4}$ "

39kgs

130703Mirror cabinet W140
3 double-sided mirror doors
LED lighting: 25.44W + 12W (under)55 $\frac{1}{8}$ " x 5 $\frac{1}{8}$ " x 28 $\frac{3}{4}$ "

42kgs

130704Mirror cabinet W150
3 double-sided mirror doors
LED lighting: 27.36W + 12.96W (under)59" x 5 $\frac{1}{8}$ " x 28 $\frac{3}{4}$ "

48kgs

Included with all: 3 double-sided mirror doors, 6 adjustable glass shelves, shaver socket, 2 light switches
Lighting: class II - IP44 - CE, Energy class: A++/A+/A

White melamine cabinets

Belleme

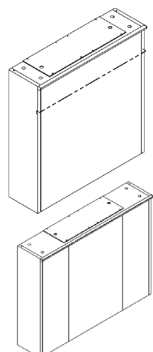

MODEL NUMBER	DESCRIPTION	W x D x H	WEIGHT
130910	Mirror cabinet W60 1 door, 2 laminate white shelves LED lighting: 5.76W - 95 lumen/W - 230V - 4500°K	23 ⁵ / ₈ " x 7 ¹ / ₁₆ " x 24 ³ / ₈ "	19.5kgs
130911	Mirror cabinet W80 3 doors, 6 white laminate shelves LED lighting: 7.68W - 95 lumen/W - 4500°K	31 ¹ / ₂ " x 7 ¹ / ₁₆ " x 24 ³ / ₈ "	22.5kgs
130912	Mirror cabinet W100 3 doors, 6 white laminate shelves LED lighting: 9.60W - 95 lumen/W - 4500°K	39 ³ / ₈ " x 7 ¹ / ₁₆ " x 24 ³ / ₈ "	25.5kgs

Included with all: Shaver socket, switch. Lighting: class II - IP44 - CE, Energy class: A++/A+/A

Neptune

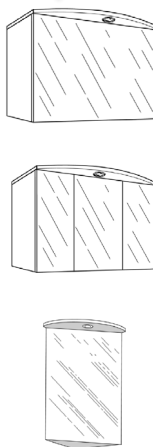

MODEL NUMBER	DESCRIPTION	W x D x H	WEIGHT
130600	Mirror cabinet W45 1 door, 2 laminate white shelves Halogen lighting: 1x20W - 12V	17 ⁹ / ₁₆ " x 7 ¹ / ₁₆ "/10 ¹ / ₄ " x 24 ³ / ₈ "	13kgs
130601	Mirror cabinet W60 3 doors, 6 white laminate shelves Halogen lighting: 1x20W - 12V	23 ³ / ₄ " x 7 ¹ / ₁₆ "/10 ¹ / ₄ " x 24 ³ / ₈ "	16kgs
130401	Mirror cabinet W80 3 doors, 6 white laminate shelves Halogen lighting: 1x20W - 12V	31 ² / ₃ " x 7 ¹ / ₁₆ "/10 ¹ / ₄ " x 24 ³ / ₈ "	22kgs
130602	Mirror cabinet W100 3 doors, 6 white laminate shelves Halogen lighting: 2x20W - 12V	38 ⁷ / ₈ " x 7 ¹ / ₁₆ "/10 ¹ / ₄ " x 24 ³ / ₈ "	28kgs
130408	Corner mirror cabinet W38 1 door, 2 white laminate shelves Halogen lighting: 1x20W - 12V	15" x 15" x 30 ¹ / ₁₆ "	16kgs

Included with all: Shaver socket, switch. Lighting: class II - IP44 - CE, Energy class: C/D/E

Maxi

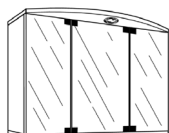

MODEL NUMBER	DESCRIPTION	W x D x H	WEIGHT
130410	Mirror cabinet W45 3 doors - 6 white laminate shelves Shaver socket - switch Halogen lighting: 1x20W - 12V Class II - IP 44 - CE Energy class: C/D/E	25 ⁵ / ₈ " x 6 ¹ / ₁₆ "/9 ² / ₃ " x 21 ³ / ₄ "	13kgs

Brillance

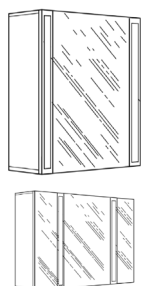

MODEL NUMBER	DESCRIPTION	W x D x H	WEIGHT
130416	Mirror cabinet W60 1 door, 2 glass shelves Fluorescent lighting: 2x18W - 230V	23 ⁵ / ₈ " x 7 ¹ / ₁₆ " x 27 ⁹ / ₁₆ "	19kgs
130605	Mirror cabinet W80 3 doors, 6 glass shelves Fluorescent lighting: 2x18W - 230V	31 ¹ / ₂ " x 7 ¹ / ₁₆ " x 27 ⁹ / ₁₆ "	22kgs
130415	Mirror cabinet W100 3 doors, 6 glass shelves Fluorescent lighting: 2x18W - 230V	39 ³ / ₈ " x 7 ¹ / ₁₆ " x 27 ⁹ / ₁₆ "	28kgs

Included with all: Shaver socket, switch. Lighting: class II - IP44 - CE - NF, Energy class: A++/A+/A

Mirage

MODEL
NUMBER

DESCRIPTION

W x D x H

WEIGHT

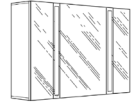
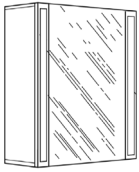

130603	Mirror cabinet W60 3 doors, 6 white laminate shelves Fluorescent lighting: 1x14W - 230V	23 ³ / ₄ " x 7" x 27 ¹ / ₁₆ "	19kgs
130402	Mirror cabinet W80 3 doors, 6 white laminate shelves Fluorescent lighting: 1x18W - 230V	31 ² / ₃ " x 7" x 27 ¹ / ₁₆ "	22kgs
130604	Mirror cabinet W100 3 doors, 6 white laminate shelves Fluorescent lighting: 1x21W - 230V	39 ³ / ₈ " x 7" x 27 ¹ / ₁₆ "	28kgs

Included with all: Shaver socket, switch. Lighting: class II - IP44 - CE - NF, Energy class: A++/A+/A